

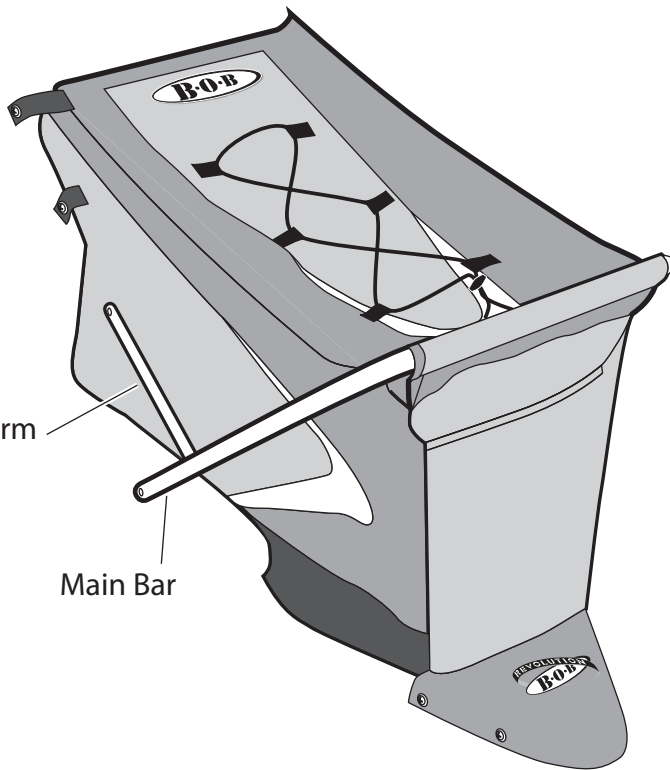

# RCCK | Revolution Cargo Conversion Kit

Congratulations on your purchase of the BOB Revolution Cargo Conversion Kit (RCCK). It's designed to easily convert your existing BOB Revolution stroller frame into a cargo carrier. Before installing the RCCK you will need to remove the stroller seat and canopy.



Pivot Nut 2x



Pivot Plug 2x

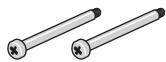

Pivot Screw 2x



Sharp Screw 2x

### TOOLS NEEDED:

- Phillips screwdriver
- 4mm hex wrench
- 8mm socket wrench

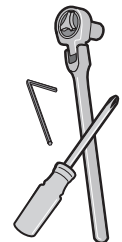

### TAKE TIME - READ AND UNDERSTAND INSTRUCTIONS COMPLETELY!

Before attempting to assemble or use your new RCCK, read and understand these assembly instructions completely, as well as the warnings at the end of this document, to insure proper assembly and safe operation.

**If you are unclear on any point, contact your dealer or BOB before use.**

## REMOVE CANOPY

**1 SET PARKING BRAKE.** See the "Parking Brake" section of your stroller owner's manual.

### 2 REMOVE FABRIC SCREWS

Remove both fabric screws from handlebar.

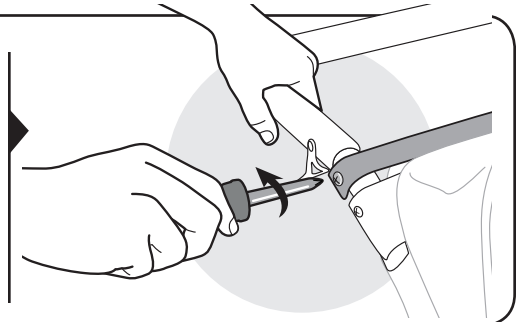
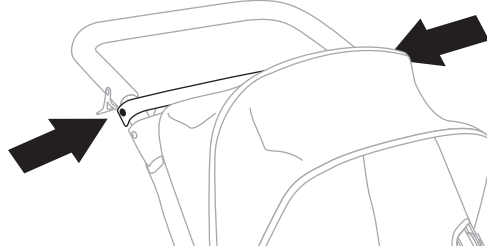

### 3 FOLD STROLLER

Compress both handlebar release levers and fold handlebar forward.

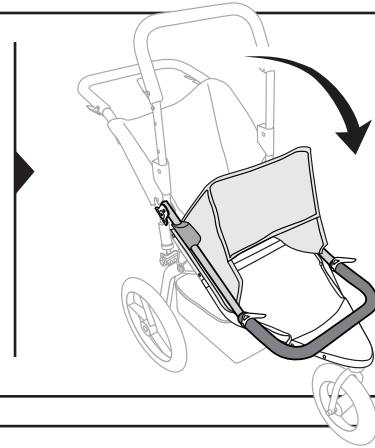
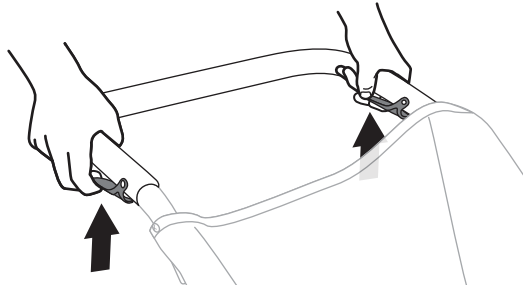

### 4 REMOVE PIVOT SCREWS

Using a 4mm hex and an 8mm socket wrench, remove both pivot screws and lock nuts. Remove Canopy.

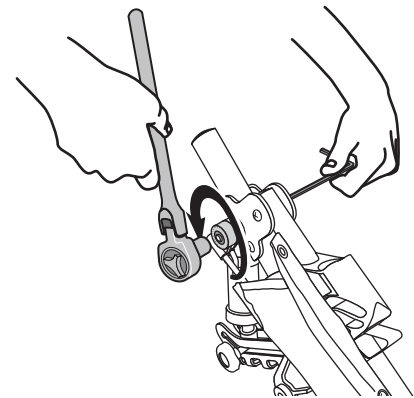
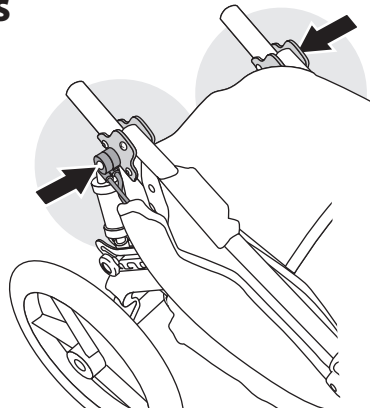

## REMOVE STROLLER SEAT

### 5 REMOVE CABLE

While holding knob, use a Phillips screwdriver to remove both cable screws.

Knob

Remove cable from seat bottom.

Cable will be reinstalled on RCCK.

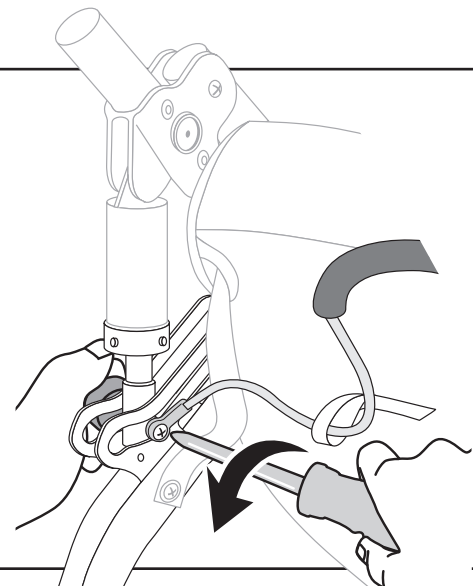
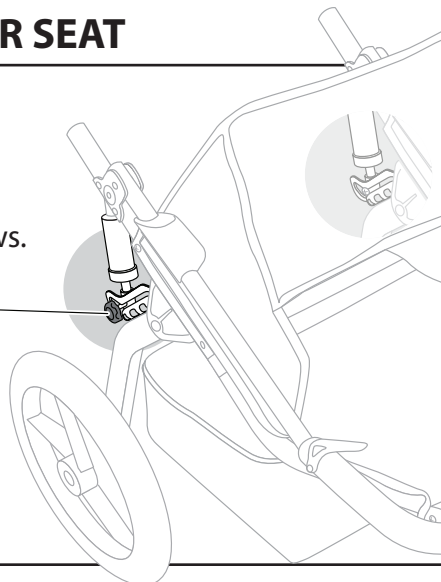

## 6 DETACH HARNESS STRAP

Using a Phillips screwdriver, remove both harness-strap screws from stroller swing arms.

NOTE: Applying heat from soldering iron may help release thread lock.

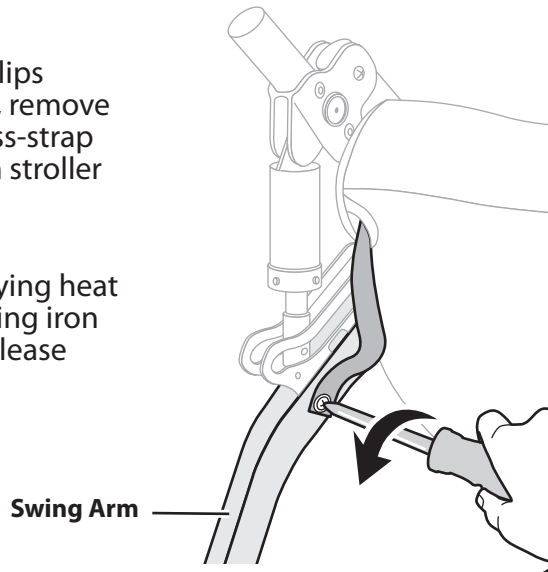

## 7 PARTIALLY DETACH LOWBOY

Using a Phillips screwdriver and 8mm socket wrench, undo both Lowboy attachments from underside of seat.

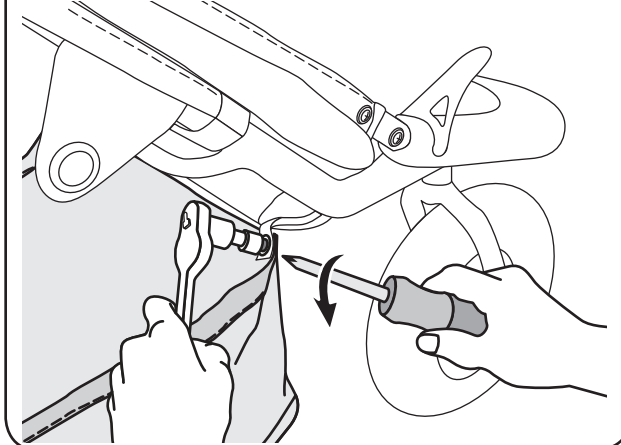

## 8 UNFOLD STROLLER

Lift handlebar until it snaps into upright position.

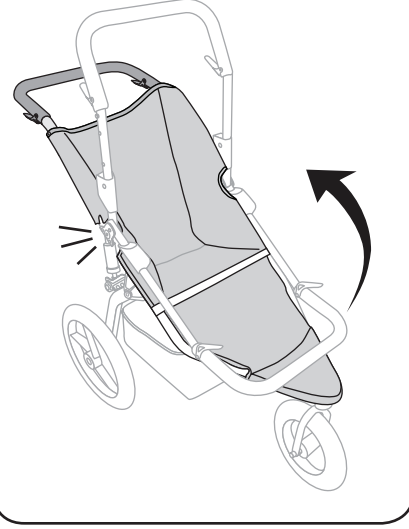

## 9 REMOVE FABRIC SEAT

Beginning at bottom, use a Phillips screwdriver to remove fabric screws.

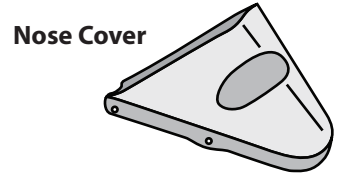
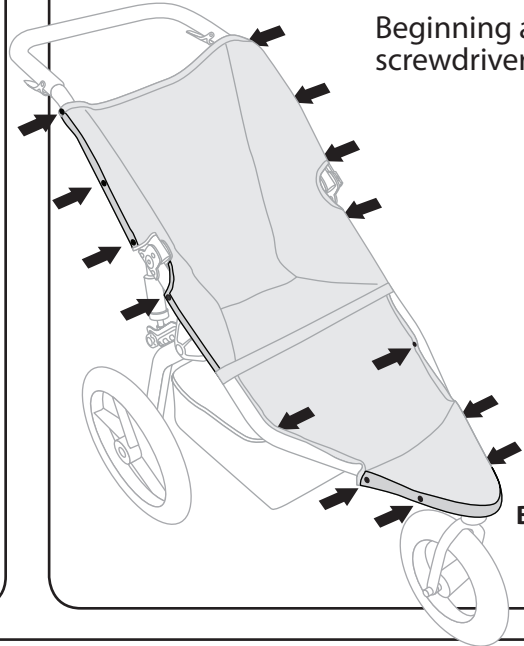

NOTE:  
Top two screws are "long" fabric screws and will not be used with RCKK.

## 10 RELEASE VELCRO SEAT STRAP

Undo velcro seat strap and remove fabric seat.

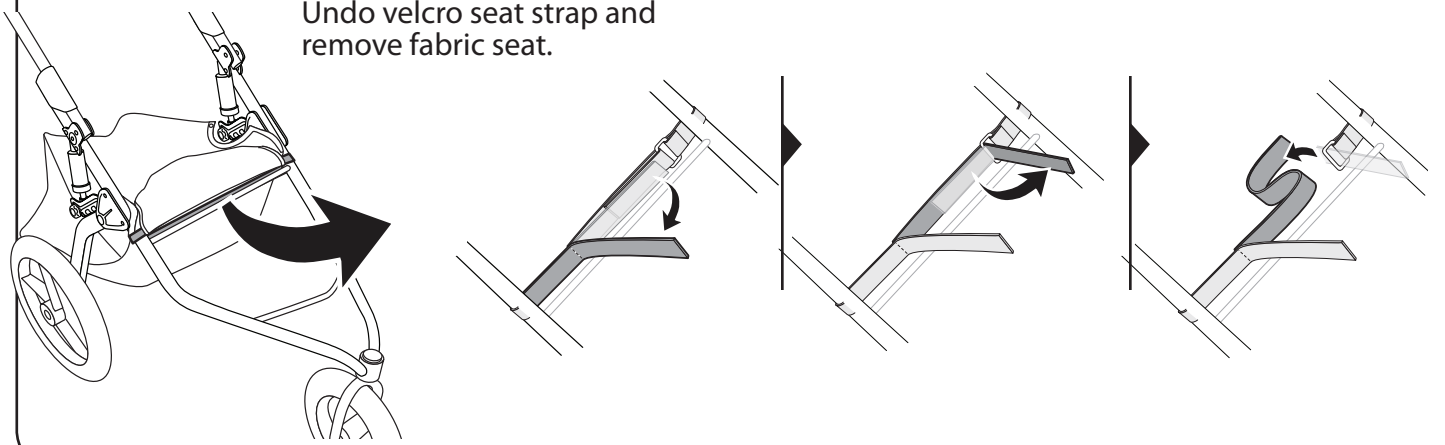

## ATTACH RCCK

### 11 ASSEMBLE SCREW, PLUG AND BAR

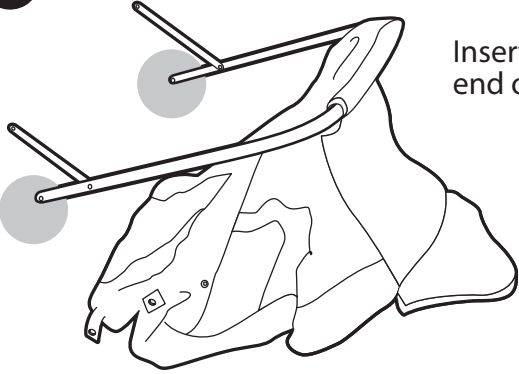

Insert one **pivot screw** through one end of **main bar** and into **pivot plug**.

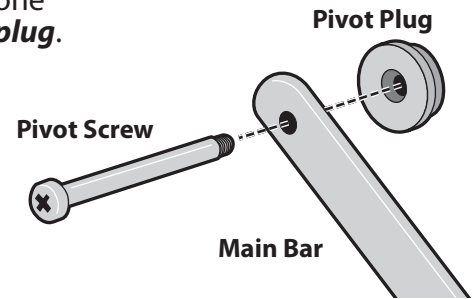

### 12 POSITION RCCK

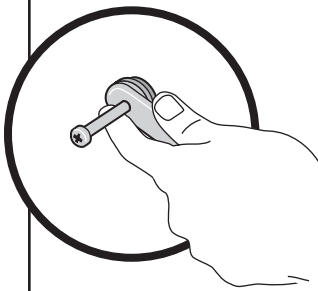

Support Arms

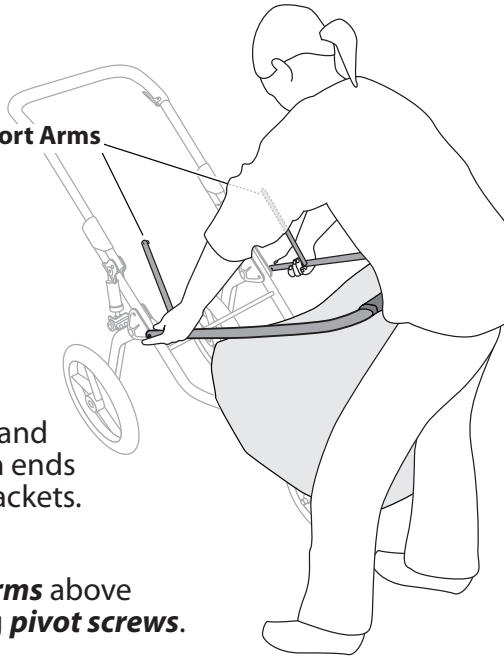

Holding **pivot screw** and **pivot plug** in place with hand on one side, position both ends of **main bar** over pivot brackets.

NOTE: Position **support arms** above **main bar** before installing **pivot screws**.

### 13 INSERT PIVOT PLUG AND SCREW

Slip **pivot plug** into opening on pivot bracket and push **pivot screw** flush against **bar**.

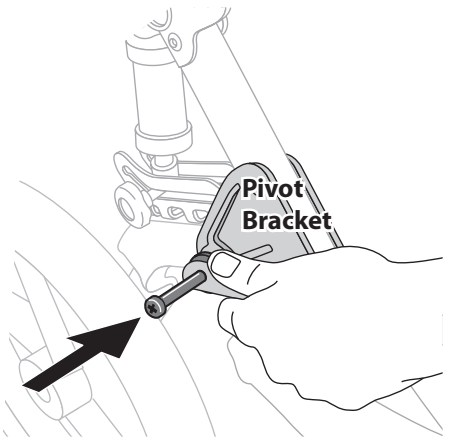

### 14 ATTACH PIVOT NUT

Slip **pivot nut** on other end of **pivot screw** and into opening on pivot bracket.

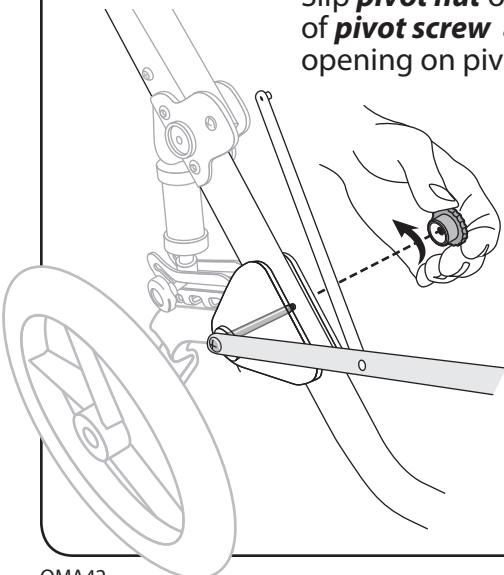

### 15 TIGHTEN PIVOT NUT

Use a Phillips screwdriver to tighten **pivot screw** clockwise, while holding **pivot nut**.

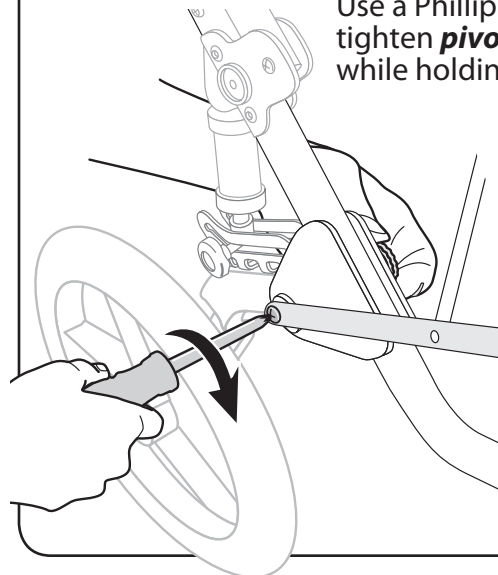

### 16 INSERT PIVOT PLUG ON OPPOSITE SIDE

Slip **pivot plug** under end of **main bar** and into opening on pivot bracket.

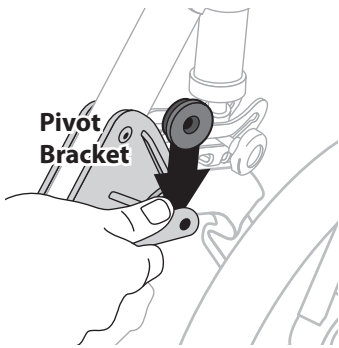

### 17 INSERT PIVOT SCREW

Insert **pivot screw** through **main bar, pivot plug** and into opening on pivot bracket.

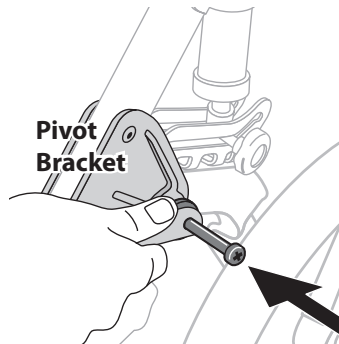

### 18 ATTACH PIVOT NUT

Slip **pivot nut** on other end of **pivot screw** and into opening on pivot bracket.

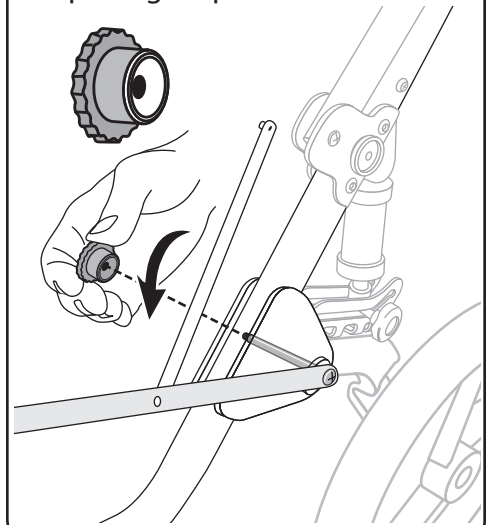

### 19 TIGHTEN PIVOT NUT

Use a Phillips screwdriver to tighten **pivot screw** clockwise, while holding **pivot nut**.

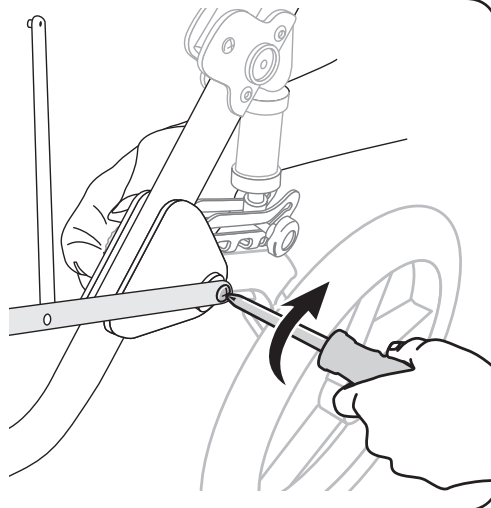

### 20 ATTACH NOSE CLIP TO NOSE COVER

Clip underside of nose fabric to plastic nose cover from stroller.

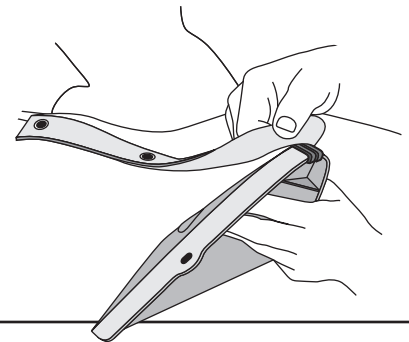

### 21 POSITION NOSE COVER

Align plastic nose cover holes with holes in stroller frame.

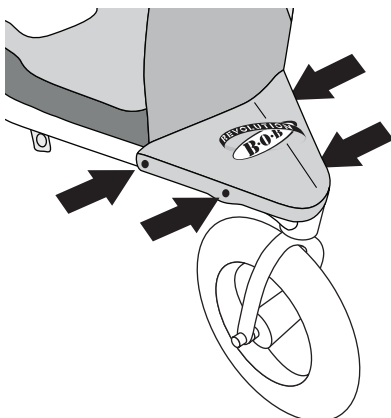

### 22 INSERT FABRIC SCREWS

Using a Phillips screwdriver, insert fabric screws. Tighten.



#### DO NOT CROSSTHREAD

If screw does not turn easily, unscrew and start again.

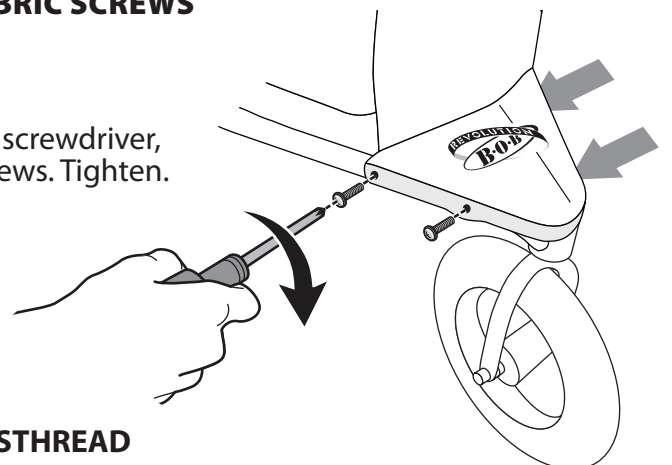



### 23 POSITION ARM

Align support arm hole with lowest threaded hole in handlebar frame.

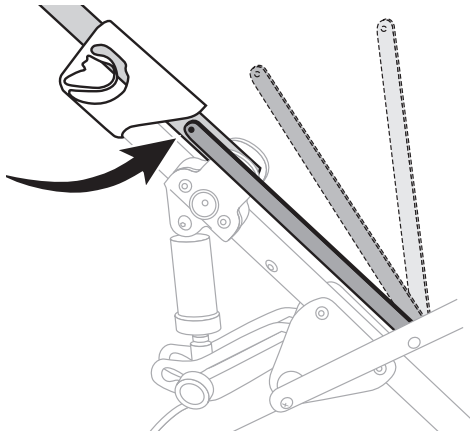

### 24 INSERT SHARP SCREW

Insert **sharp screw** through end of **support arm** and into handlebar.

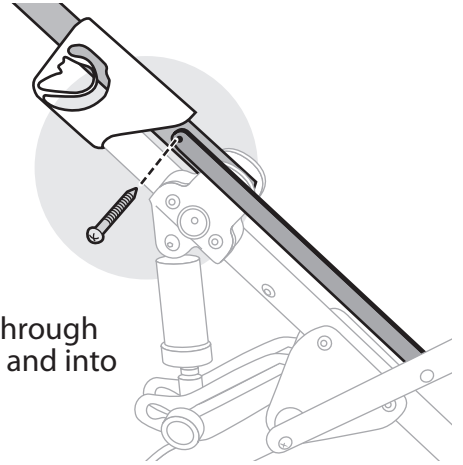

### 25 TIGHTEN SHARP SCREW

Tighten firmly with Phillips screwdriver.



#### DO NOT CROSSTHREAD

If screw does not turn easily, unscrew and start again.

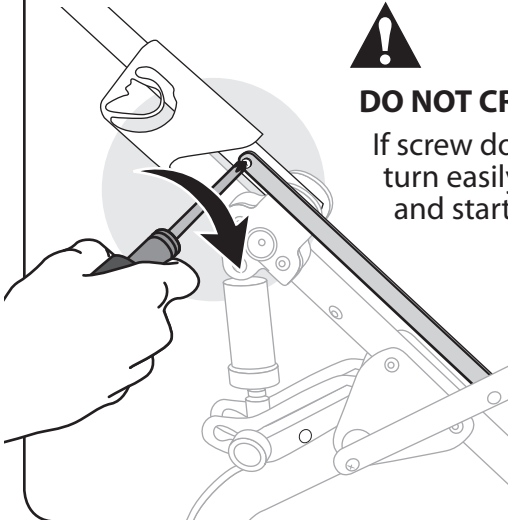

### 26 ATTACH RCCK FABRIC

Beginning at top, use a Phillips screwdriver and insert fabric screws.

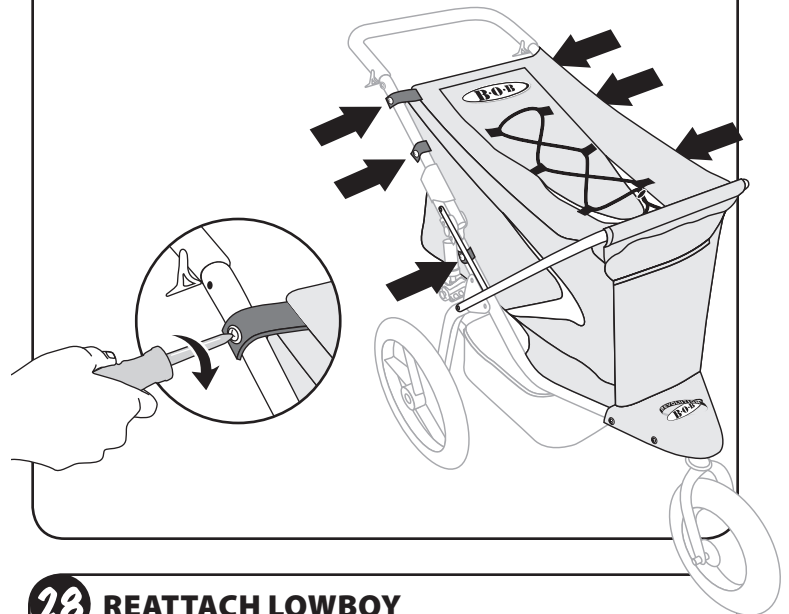

### 27 FOLD STROLLER

Compress both handlebar release levers and fold handlebar forward.

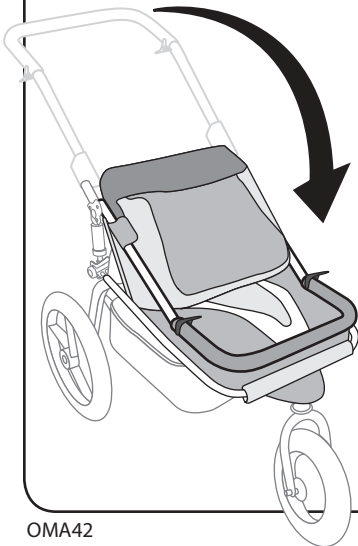

### 28 REATTACH LOWBOY

Using a Phillips screwdriver and 8mm-socket wrench, reattach lowboy to underside of RCCK.

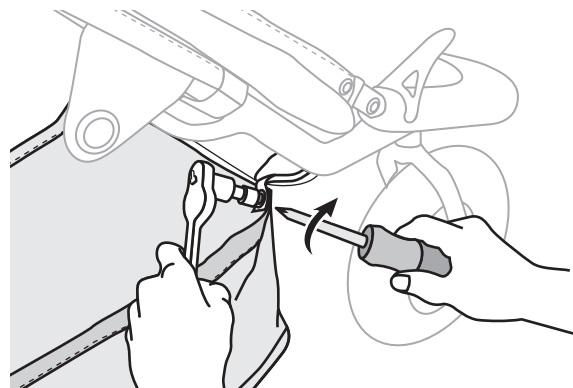

## 29 POSITION CABLE

Route cable through upper loops on underside of RCCK. Red handle should rest between upper loops.

Continue routing through lower loops.

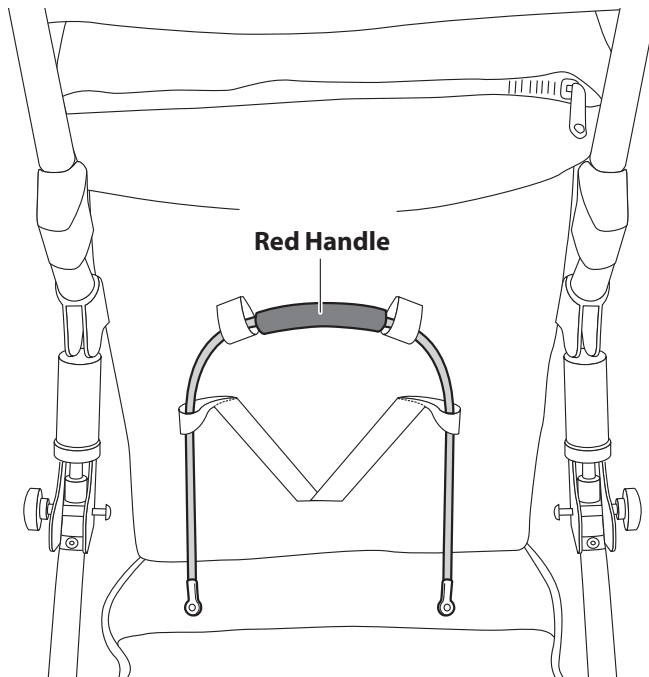

## 30 REATTACH CABLE

Holding knob with one hand, insert screw through cable end and align with inside knob hole. Tighten screw.

Repeat on opposite side with unattached cable end.

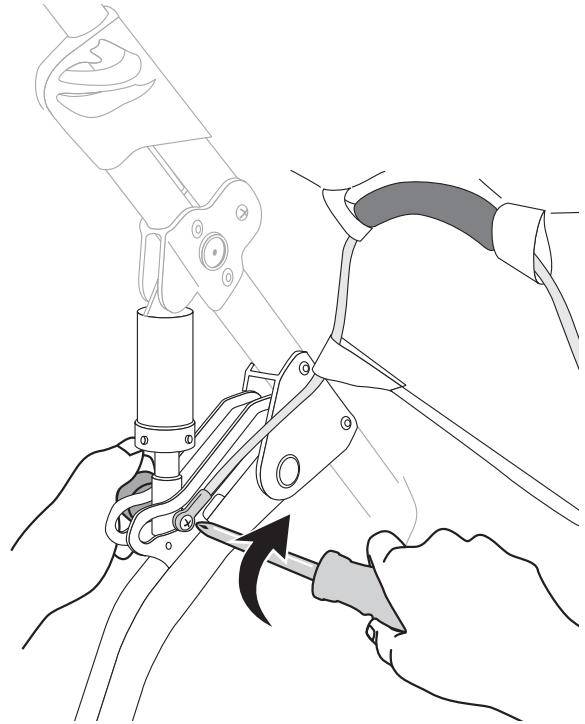



# Revolution Cargo Conversion Kit Warnings



- *This product is not designed to be used as a stroller, children and other living things should never be placed inside or on top of the RCCK.*
- *The BOB Revolution Cargo Conversion Kit is designed for use with the BOB Revolution strollers. This product was not designed for, nor will it fit any BOB fixed-wheel or duallie strollers.*
- *Read and understand all owner's manuals and warnings for all BOB products used with the RCCK before use. If you are unclear on any point, contact your dealer, place of purchase or BOB [toll free 1-800-893-2447] before use. A list of dealers is listed on our website [www.bobgear.com]. For updates to this manual, our warranty and for other recent product notifications, please visit www.bobgear.com periodically.*
- *Follow assembly instructions. Failure to properly install this accessory product may result in accidents, damage or injury. If you are not sure you can properly install this accessory, contact your BOB retailer and arrange for them to perform the installation.*
- *Do not use the RCCK off-road or on uneven terrain. Doing so may result in accidents, damage or injury.*
- *B.O.B is a registered trademark of BOB Trailers, Inc.*

## LIMITED WARRANTY

**BOB Trailers Inc. takes pride in its workmanship and strives to manufacture the best products possible. Therefore, we warranty our BOB RCCK against defects in material and workmanship subject to the conditions listed below. Since no product is indestructible, it does not cover defects attributable to or resulting from normal wear, abuse or alteration.**

- *The RCCK is warranted for one year.*
- *Warranty is only valid for the original purchaser.*
- *Proof of purchase is required to exercise this warranty.*
- *Labor and transportation are not included.*
- *Normal wear, neglect, abuse, accidents, improper assembly or maintenance, or the installation of parts or accessories not compatible with the original intended use of the cargo carrier, as sold, are not covered by this warranty.*
- *Warranty claims must be made through an authorized dealer.*
- *This warranty is limited to the replacement of the defective part. BOB Trailers shall in no event be responsible for consequential or special damages.*
- *This limited warranty is the only express or implied warranty applicable to BOB Trailers. Any implied warranties, including warranties of merchantability and fitness shall be limited in scope and duration in accordance with this limited warranty.*

**BOB IS NOT RESPONSIBLE FOR INJURY, DAMAGE OR FAILURE THAT RESULTS FROM OWNERS FAULTY ASSEMBLY OR MAINTENANCE AFTER SHIPPING.**